

Actively Cooled Vertical Stack Diode Laser

Vsilk3-2000



Features

- High effective energy
- High Peak Power
- High reliability
- Compact structure

Applications

- Hair removal

Product Dimensions (mm)

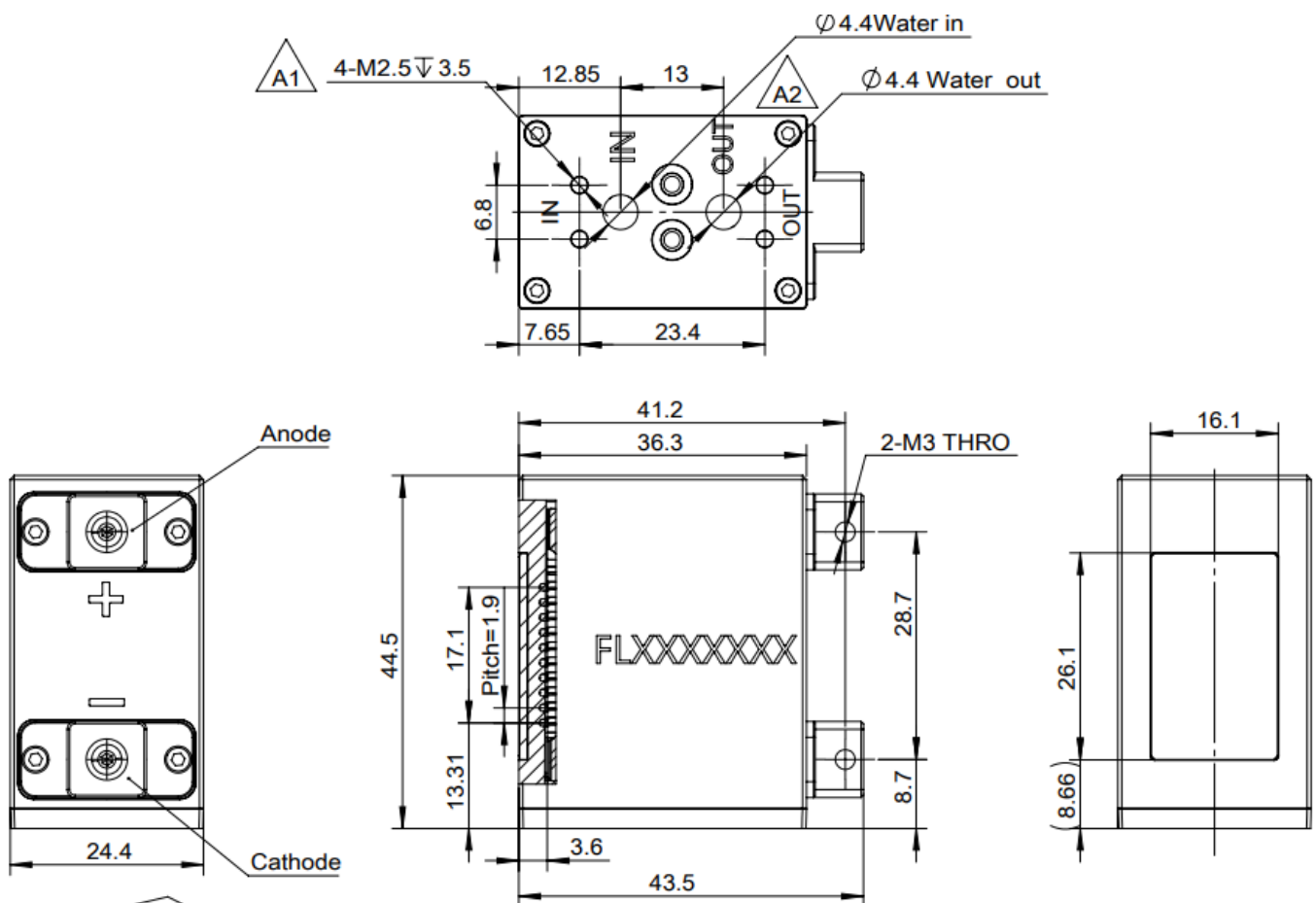

Remark: The structure drawing is for reference only. Please feel free to contact us for any special requirements.

Product Specifications

Product Code

Part No. ¹

(Typical Configuration)

FL-Vsilk3-10x1-2000-808-Y

Optical Data ²	Unit	Value
Centroid Wavelength	nm	808
Wavelength Tolerance	nm	± 15
Output Power ³	W	2000
Pulse Width	ms	20
Duty Cycle	%	20
Number of bars	-	10
Bar to Bar Pitch	mm	1.9
Fast Axis Divergence 95% with FAC	°	8 ~ 10
Slow Axis Divergence 95%	°	12 ~ 14
Emitting Area Size	mm	17.1 × 10
Wavelength Temp. Coefficient	nm/°C	~ 0.32

Electrical Data ²

Operation Current	A	< 178
Threshold Current	A	≤ 20
Operating Voltage	V	≤ 20
Slope Efficiency per Bar	W/A	≥ 1.2
Power Conversion Efficiency	%	≥ 55%
Typical Working Condition	-	2000W@20ms-10Hz 1200W@40ms-10Hz

Miscellaneous Data

Operating Temperature ⁴	°C	22 - 28
Coolant ⁵	-	Purified water with ion exchange resin filter
Coolant Flow Rate	L/min	3-3.6
Coolant Pressure	MPa	~0.35

¹Part No. = Brand Code - Series - Power - Centroid Wavelength .

²Data at 25°C unless otherwise stated.

³Reduced lifetime if used above nominal operating conditions.

⁴A non-condensing environment is required for storage and operation below ambient dew level.

⁵Coolant and filter need to be replaced every three months.



Energy Table

VsilK3-10x1-2000 Energy Table													
Energy(J)		Frequency(Hz)										Iop	
		1	2	3	4	5	6	7	8	9	10		~173A
Pulse Width (ms)	10	20	20	20	20	20	20	20	20	20	20		~150A
	20	40	40	40	40	40	40	40	40	40	40		~140A
	30	50	50	50	50	50	50	50	50	50	50		~125A
	40	60	60	60	60	60	60	60	60	60	60	Water Temperature T=25±3°C Flow Rate: 3~3.6L/min	
	50	75	75	75	75	75	75	75					
	60	90	90	90	90	90	90						
	70	91	91	91	91	91							
	80	104	104	104	104								
	90	117	117	117									
	100	130	130										
200	260												

